

# enteral

## What is the **AMT Introducer?**

The AMT Introducer is a device designed to stiffen the shaft of a Mini Compact Balloon Button (Mini-Button) making it easier to change.



For illustration Only.  
Mini-Button Sold Separately

Direct Code	NHS Code
4-5000	FWM864

[www.gbukenteral.com](http://www.gbukenteral.com)

AMT  
**INTRODUCER**

# enteral

#### **GBUK Enteral Ltd**

Blackwood Hall Business Park,  
North Duffield, Selby,  
North Yorkshire,  
YO8 5DD

**T: +44 (0)1757 282 945**

F: +44 (0)1757 600 545

**[info@gbukenteral.com](mailto:info@gbukenteral.com)**

[www.gbukenteral.com](http://www.gbukenteral.com)



Enteral UK is a trading name of  
GBUK Enteral Ltd © Copyright 2013

ENT-108

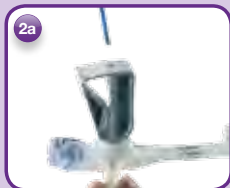
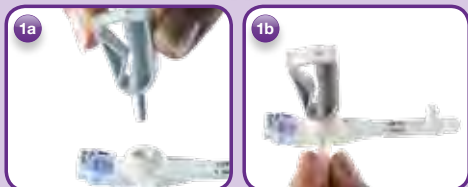

**It may be useful to use the AMT Introducer with the Mini-Button if the stoma tract is;**

- Long
- Tight
- Not straight

The AMT Introducer comes in two parts a clamp and a soft plastic stiffening stylet.

1. Insert the rounded tip of the clamp into the new Mini-Button feeding port.
2. Insert the stiffener through the clamp until it reaches to just before the end of the Mini-Button shaft
3. Lock the stiffener in place by squeezing the AMT Introducer Clamp shut. Verify the stiffener is locked in after clamping.
4. Insert the Mini-Button into the stoma as normal. It may be useful to hold the shaft of the Mini-Button close to the tip to initiate entry into the stoma.
5. Once the Mini-Button is fully inserted, unclamp the AMT Introducer Clamp and remove the stylet.

**IMPORTANT:** To avoid damage to the Mini-Button's internal valve, always remove the stylet before the AMT Introducer Clamp.

6. Gently remove the AMT Introducer Clamp while holding the Mini-Button's external bolster against the patient to prevent inadvertent feeding device removal.
7. Inflate the retention balloon to the volume shown on the balloon inflation port

**Use only the AMT Introducer to stiffen the Mini Button. No other object should be placed into the Mini-Button to aid insertion.**

The AMT Introducer should only be used with an AMT Mini Compact Balloon Button it is not designed for use with other types of gastrostomy device.